

Coil Wing Nut

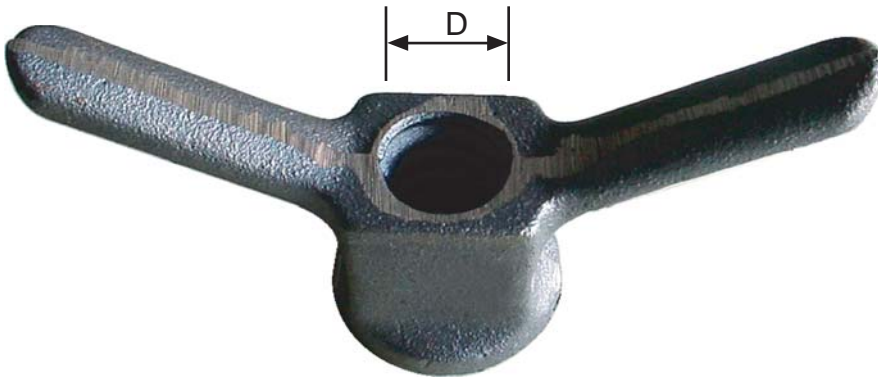

To Order
(Call, Fax or e-mail this form)

1. Part No. : _____

2. Size : _____

3. Quantity : _____

Phone : 1-866-457-5710

Fax : 1-847-541-9338

e-mail : sales@ocm-inc.com

| OCM Part No. | D Size | Weight per pcs lbs | Safe Working Load lbs |
|-----------------|-----------|-----------------------|--------------------------|
| CWN50 | 1/2" | 0.65 | 9,000 |
| CWN75 | 3/4" | 0.90 | 18,000 |
| CWN100 | 1" | 1.07 | 38,000 |
| CWN125 | 1-1/4" | 1.22 | 56,000 |
| CWN150 | 1-1/2" | 2.85 | 68,000 |

-SWL provides a safety factor of approximately 2 to 1.